

3 Connection C - Attach Sunflower To Swing Arm

CAUTION!

Do not hang anything from the Sunflower Showerhead or Swing Arm.

Make sure that the Swing Arm Adjustable Screws are tight.

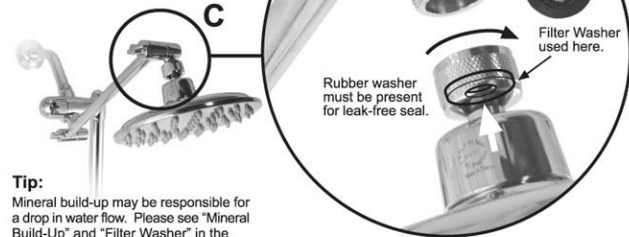

Tip: Mineral build-up may be responsible for a drop in water flow. Please see "Mineral Build-Up" and "Filter Washer" in the CAUTION & CARE section for more information.

4 Connection D - Attach Hose To Diverter

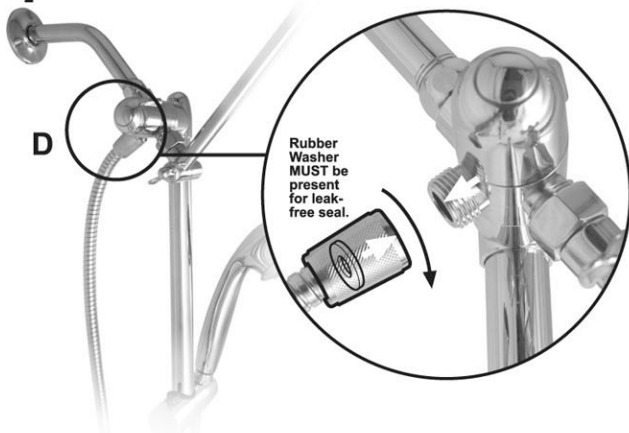

5 Connection E - Attach Hose To Hand Shower

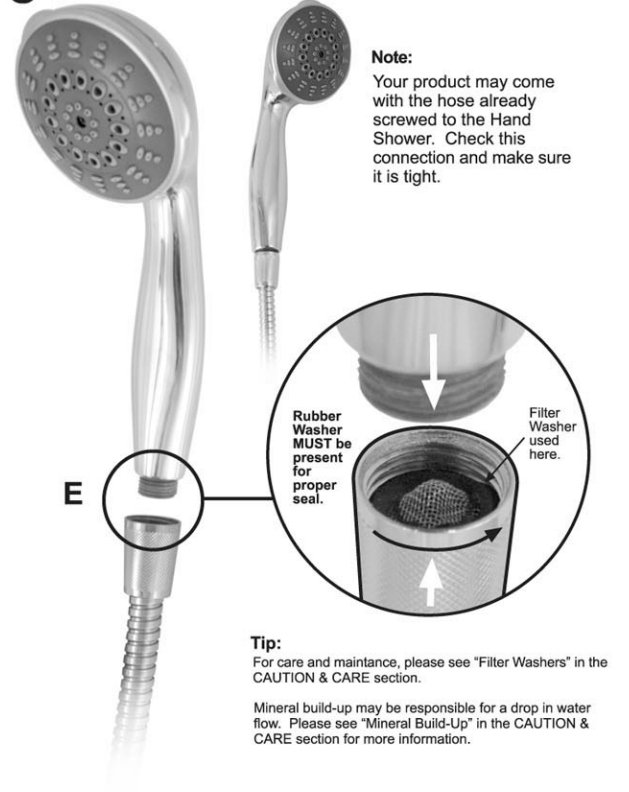

Note: Your product may come with the hose already screwed to the Hand Shower. Check this connection and make sure it is tight.

Tip: For care and maintenance, please see "Filter Washers" in the CAUTION & CARE section.

Mineral build-up may be responsible for a drop in water flow. Please see "Mineral Build-Up" in the CAUTION & CARE section for more information.

Hand Shower Adjustable Mount

Pinch Release Button and move Hand Shower Adjustable Mount up or down.

CAUTION!

Care should be taken when moving the Hand Shower Adjustable Mount up or down.

Be sure that the Slide Bar is free of any soap, shampoo or cleaning agent as these substances could cause the Hand Shower Adjustable Mount to lose its grip on the bar and slide down.

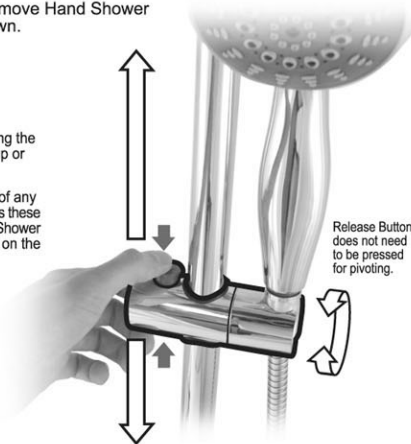

Diverter Valve

Turn the Diverter Handle to route water flow to the desired showerhead.

TIP:

- Water can be sent to:
 - Sunflower Showerhead
 - Hand Shower
 - both showerheads

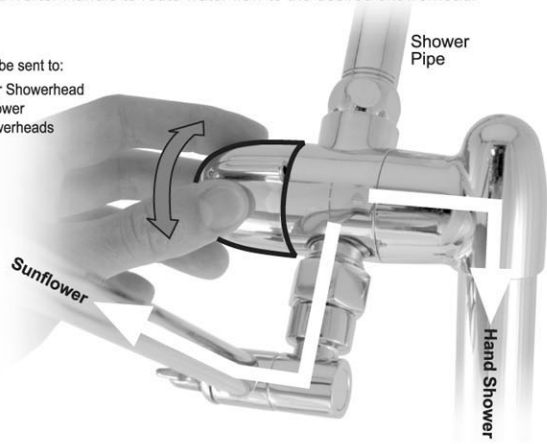

Hand Shower Spray Selections

Turn spray face to select any 1 of 5 desired sprays.

TIP:

Spray face can be turned in either direction however there is a stop point.



CAUTION & CARE

CAUTION - Slide Bar

If soap, shampoo or any shower cleaning product is applied to the Slide Bar, the Hand Shower Adjustable Mount may lose its grip and slide to the bottom of the bar. To restore the grip of the Hand Shower Adjustable Mount on the bar, the bar should be washed totally clean with plain water.

CAUTION - Sunflower Showerhead & Swing Arm

Do not hang anything from the Swing Arm and Sunflower Showerhead. Be sure the Adjustment Screws on the Swing Arm are sufficiently tight after adjusting the position of the Swing Arm. Periodically check the Adjustment Screws to make sure they are tight and that the Swing Arm is secure.

Cleaning

Do not use harsh chemicals, abrasive cleaners or textured sponges / cloths to clean this product. This may damage the surface finish and void the warranty. Most popular shower cleaning products are suitable for cleaning the product surfaces of water marks, mineral deposits and soap scum. Always rinse all product surfaces clean of any cleaning product residue with clear water. Towel dry for a spot free shine.

Mineral Build-up

Due to hard water mineral build up, water flow through the Sunflower and Hand Shower spray nozzles may become restricted. The nozzles are easily cleaned by flexing the rubber spray jets which will break up the mineral deposits and restore full water flow through them. If mineral build-up is excessive, the Hand Shower or Sunflower spray nozzle can be soaked in household vinegar or a popular commercial shower cleaning product.

Filter Washers

Two filter washers are used in this product - one in the Sunflower Showerhead plumbing connection and one in the Handshower plumbing connection. These filter washers should be inspected and cleaned periodically, removing any mineral deposits or other matter. If water flow from either showerhead ever appears to be less than normal, the respective filter washer should be inspected and cleaned to help restore proper water flow.

Due to continuing improvements, your product may differ slightly from the product described herein.

Questions? Assistance?

Do you have questions about the installation or functions of this product?

1-800-776-6364
8am to 5pm Pacific Time

www.showertek.com